

1



After expanding the SpineJack® implant, unscrew the butterfly nut with 4-5 turns to release the pressure while holding the grey handle.

2



Hold the grey handle and unscrew the coloured end-piece with 10 turns.



Hold the grey handle and start to pull on the coloured end-piece.

3



Release the handle and remove the coloured end-piece completely.

1

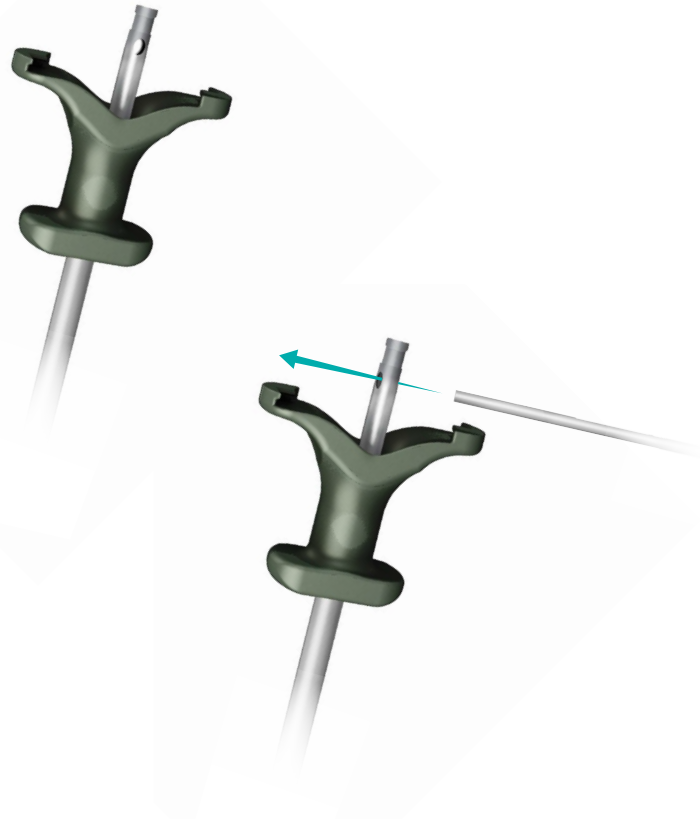

Remove the cement pusher or the Injector Transfer Tube.
Introduce a guide-wire inside the hole of the upper extremity of the implant expander tube, placed inside of the working cannula.

2

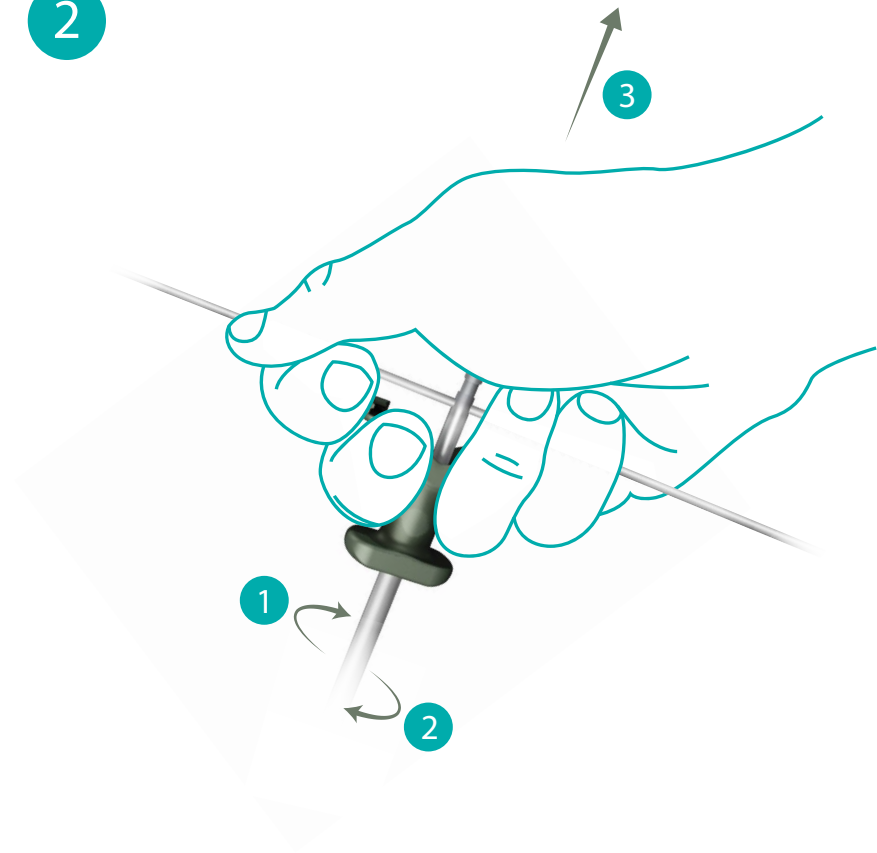

Apply a rotative force associated to the pull-out force, to dissociate the working cannula and the expander tube from the implant.
Remove the working cannula and the expander tube from the patient's body.